

- Skidanje črne ploče
- Removing the transparent plate
- Demontaža čelne plošče

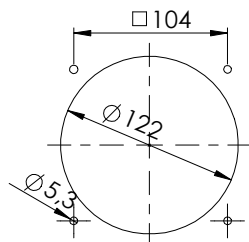

Stražnji lim
Rear panel
Zadnja plošča

- Odvojena ugradnja "O"
- Rear mounting
- Montaža zadaj

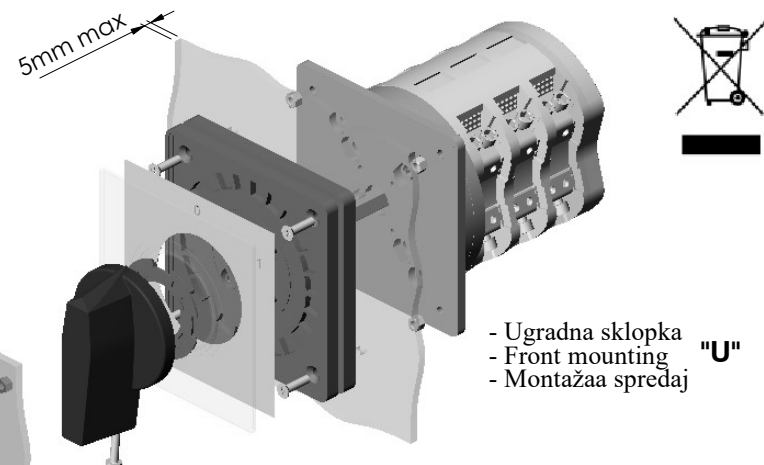

- Ugradna sklopka
- Front mounting
- Montaža spredaj

"U"

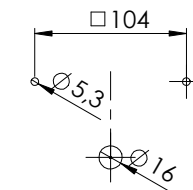

Prednji lim
Front panel
Sprednja plošča

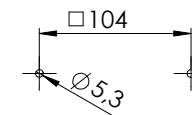

Stražnji lim
Rear panel
Zadnja plošča

- Sklopke preko 6 elemenata obvezno pričvrstiti s prenje i stražnje strane
- Switches with more than 6 elements must be fixed on the both side (front and rear)
- Stikala z več kot 6 elementi morajo biti pritjeni na obeh straneh (spredaj in zadaj)

Serija Series G/4G				4G200	G315	4G400	G630	G900	G1200	G1600	G2000
Nazivni izolacijski napon		Ui	V	690	690	690	690	690	690	690	690
Rated insulation voltage	IEC		V	690	690	690	690	690	690	690	690
Nazivna izolacijska napetost	UL		V	600	600						
Nazivna termička struja		Ith	A	200	315	400	630	900	1200	1600	2000
Rated thermal current			A	200	315	400	630	900	1200	1600	2000
Nazivni termični tok											
Nazivni udarni podnosivi napon		Uimp	kV	8	8	8	8	8	8	8	8
Rated impulse withstand voltage			kV	8	8	8	8	8	8	8	8
Nazivna impulzna napetost	IEC (III/3)										
Nazivna pogonska struja	AC1/AC21B	le	A	200	315	400	630	900	1200	1600	2000
Rated operation current			A	200	315	400	630	900	1200	1600	2000
Nazivni delovni tok											
Priključni vijak		M		10	10	12	12	16	16	4x12	4x12
Terminal screw				10	10	12	12	16	16	4x12	4x12
Priključni vijak											
Moment pritezanja priključnega vijka		Nm		10	10	14	14	25	25	14	14
Terminal tightening torque			Nm	10	10	14	14	25	25	14	14
Pritezni moment priključka											

AMPERMETARSKE SKLOPKE / AMMETER SWITCHES / STIKALA ZA PREKLOP AMPERMETRA

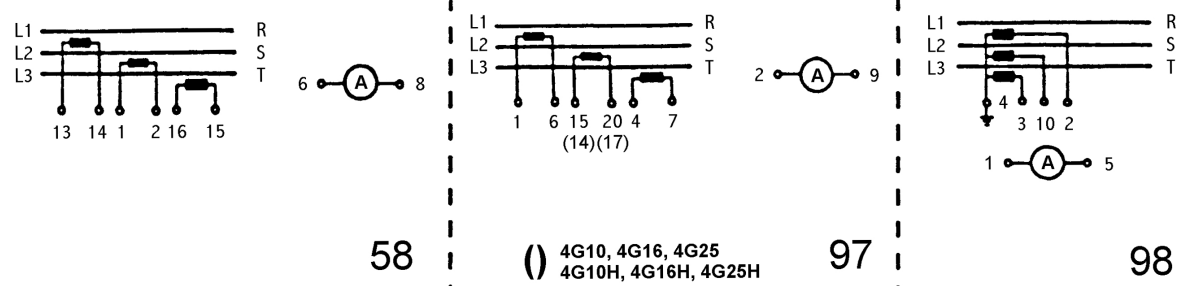

VOLTMETARSKO - AMPERMETARSKE SKLOPKE / VOLTMETER - AMMETER SWITCHES / STIKALA ZA PREKLOP VOLTMETRA - AMPERMETRA

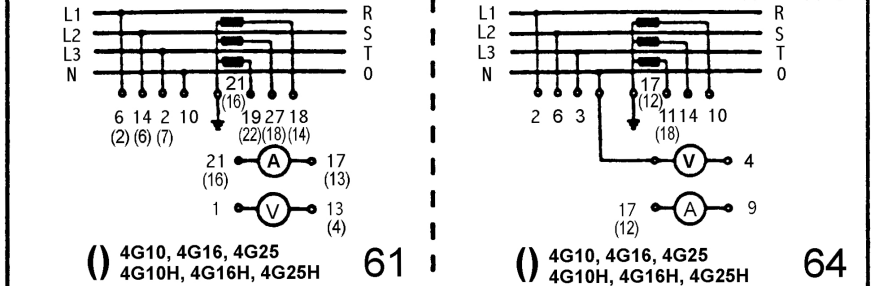

VOLTMETARSKE SKLOPKE / VOLTMETER SWITCHES / STIKALA ZA PREKLOP VOLTMETRA

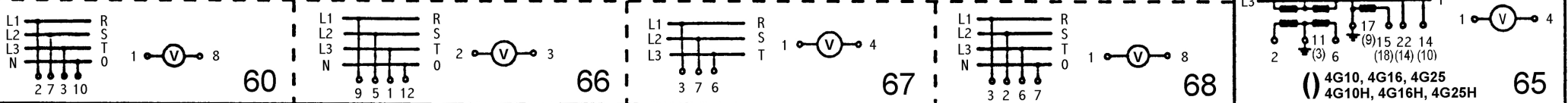

SKLOPKE SA POVRATOM - KUT ZAKRETA 30° / SWITCHES SPRING RETURN WITH 30° SWITCHING / AVTOMATSKO VRAČANJE V POLOŽAJ - STIKALNI KOT 30°

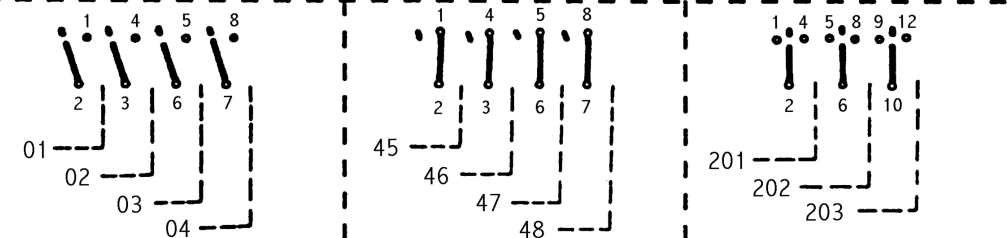

SKLOPKE ZA POKRETANJE JEDNOFAZNIH MOTORA / START AND RUN SWITCHES / STIKALA ZA VKLAPLJANJE ENOFAZNIH MOTORJEV

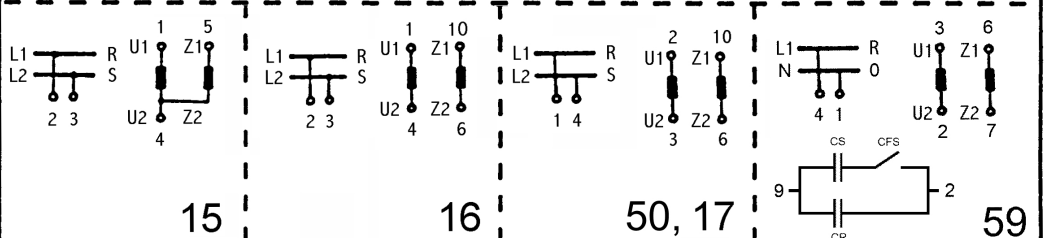

UPRAVLJAČKE SKLOPKE SA POVRATOM / CONTROL SWITCHES (WITH SPRING RETURN) / STIKALA Z AVTOMATSKIM VRAČANJEM V POLOŽAJ

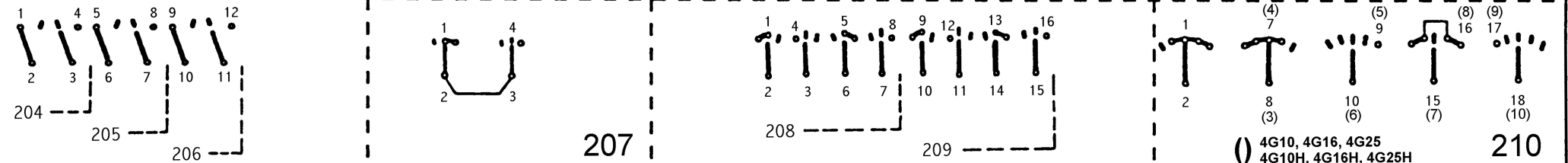

MOTORSKE REVERZIJNE SKLOPKE / MOTOR REVERSING SWITCHES / STIKALA ZA VKLAPLJANJE MOTORJEV - DVE SMERI VRTENJA

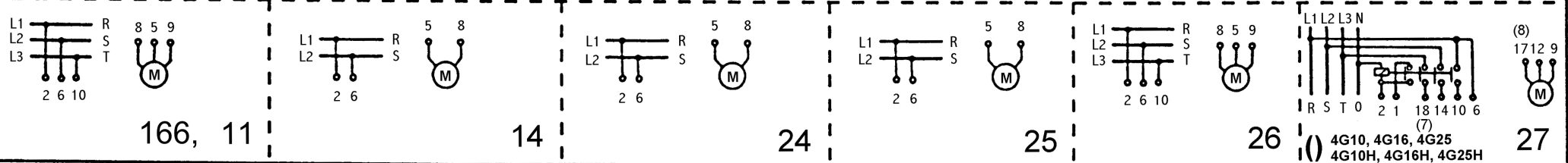

ZVIJEZDA - TROKUT SKLOPKE / STAR - DELTA SWITCHES / STIKALA ZA PREKLOP ZVEZDA - TRIKOT

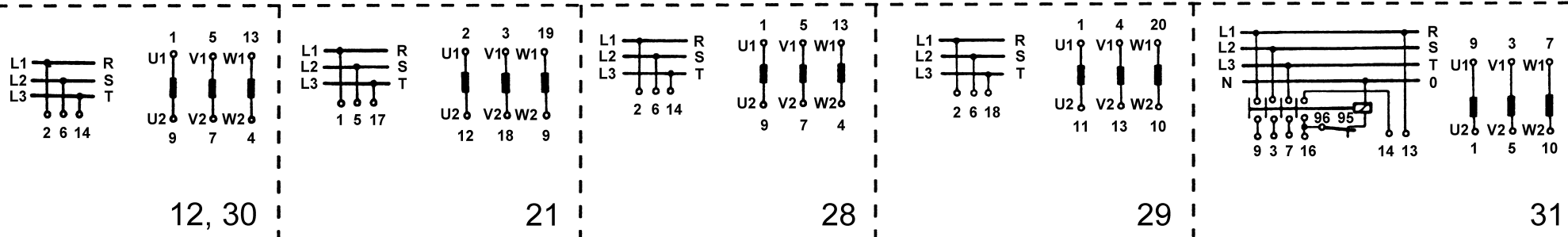

SKLOPKE ZA UPRAVLJANJE MOTORIMA (ODVOJENI NAMOTI) / MOTOR CONTROL SWITCHES (SEPARATE WINDINGS) / STIKALA ZA VKLAPLJANJE MOTORJEV (LOČENA NAVITJA)

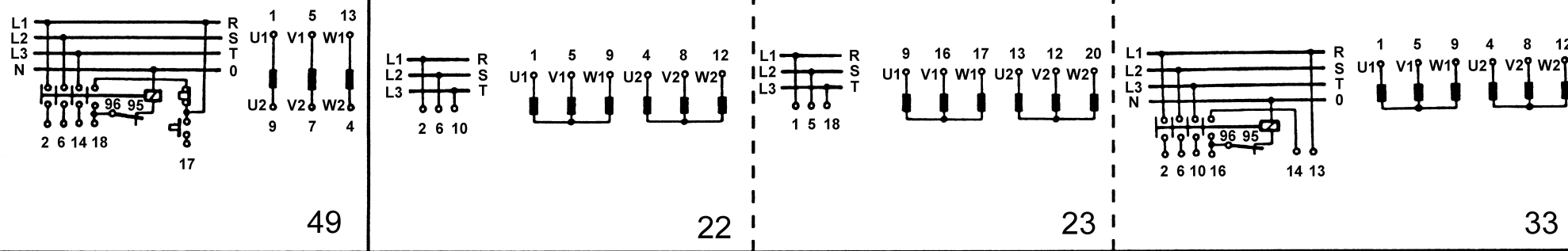

SKLOPKE ZA UPRAVLJANJE MOTORIMA (DAHLANDER) / MOTOR CONTROL SWITCHES (DAHLANDER) / STIKALA ZA VKLAPLJANJE MOTORJEV (DAHLANDER)

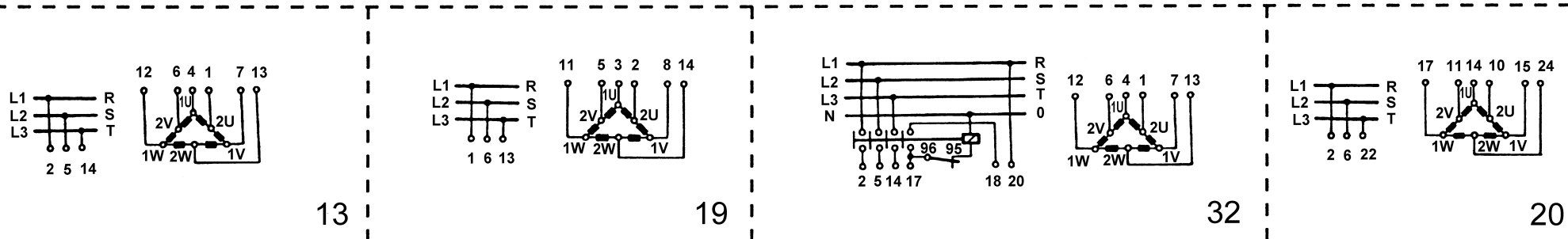

SKLOPKE ZA UPRAVLJANJE TROBRZINSKIM MOTORIMA / SWITCHES FOR 3-SPEED MOTOR CONTROL / STIKALA ZA VKLAPLJANJE MOTORJEV - TRI HITROSTI

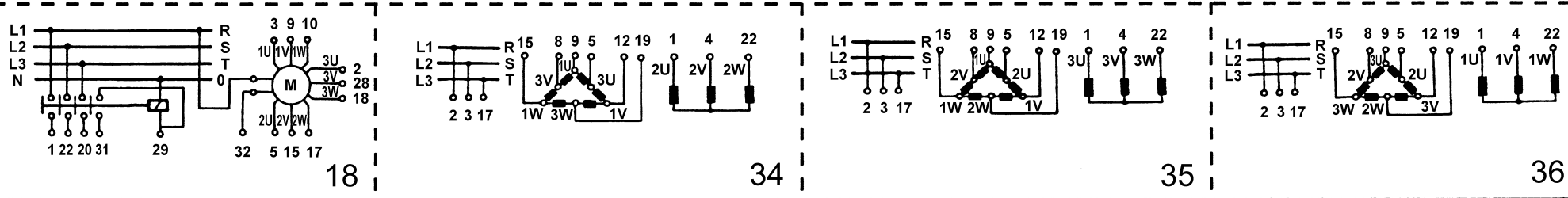

SKLOPKE SA KUTEM ZAKRETA 60°
SWITCHES WITH 60° SWITCHING
STIKALA S STIKALNIM KOTOM 60°

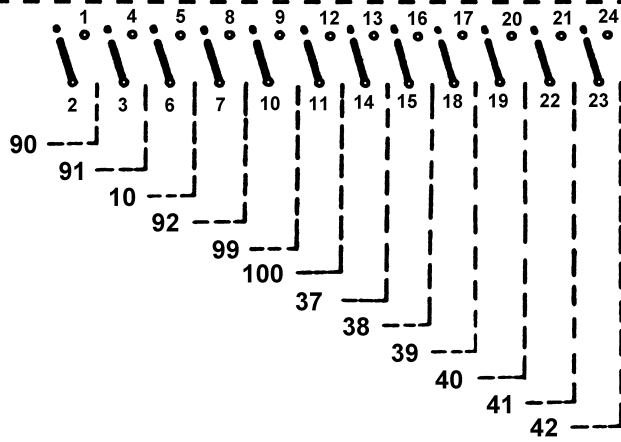

PREKLOPKE SA "0" POLOŽAJEM SA KUTEM ZAKRETA 60°
CHANGEOVER SWITCHES WITH "0" 60° SWITCHING
PREKLOPNA STIKALA S POLOŽAJEM "0" IN STIKALNIM KOTOM 60°

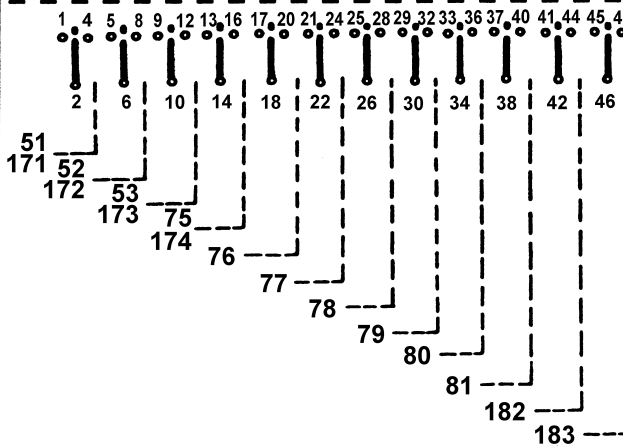

PREKLOPKE BEZ "0" POLOŽAJA SA KUTEM ZAKRETA 90°
CHANGEOVER SWITCHES WITHOUT "0" 90° SWITCHING
PREKLOPNA STIKALA BREZ POLOŽAJA "0" IN STIKALNIM KOTOM 90°

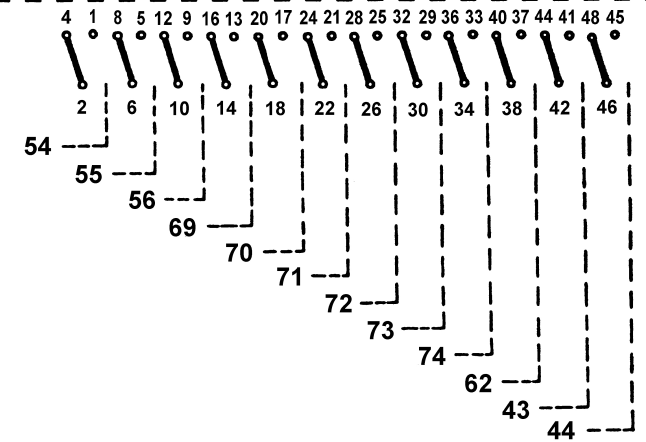

SKLOPKE SA KUTOM ZAKRETA 90° / SWITCHES WITH 90° SWITCHING / STIKALA S STIKALNIM KOTOM 90°

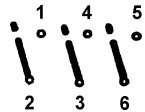
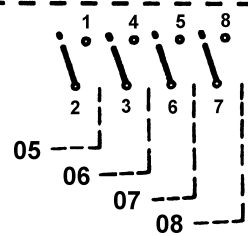

09

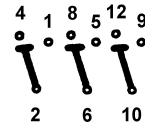

57

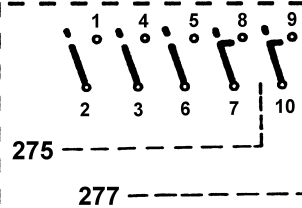

277

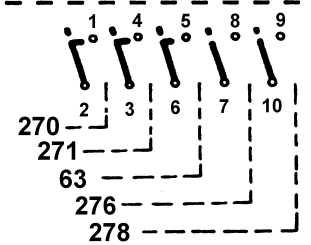

270, 271, 63, 276, 278

STEPENASTE SKLOPKE BEZ "0" POLOŽAJA / MULTI-STEP SWITCHES WITHOUT "0" / STOPENJSKA STIKALA BREZ POLOŽAJA "0"

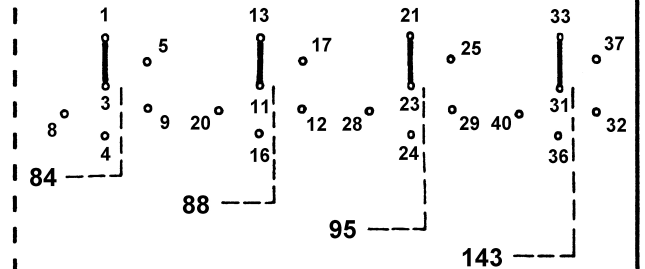
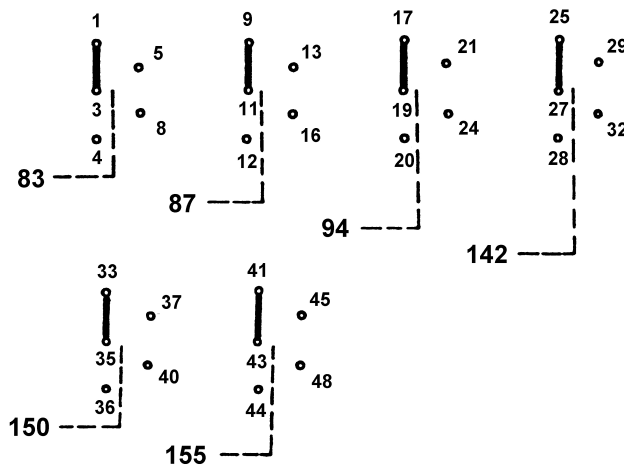
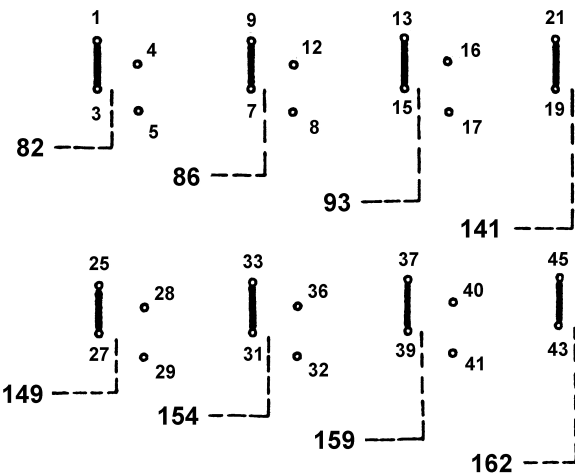

STEPENASTE SKLOPKE BEZ "0" POLOŽAJA / MULTI-STEP SWITCHES WITHOUT "0" / STOPENJSKA STIKALA BREZ POLOŽAJA "0"

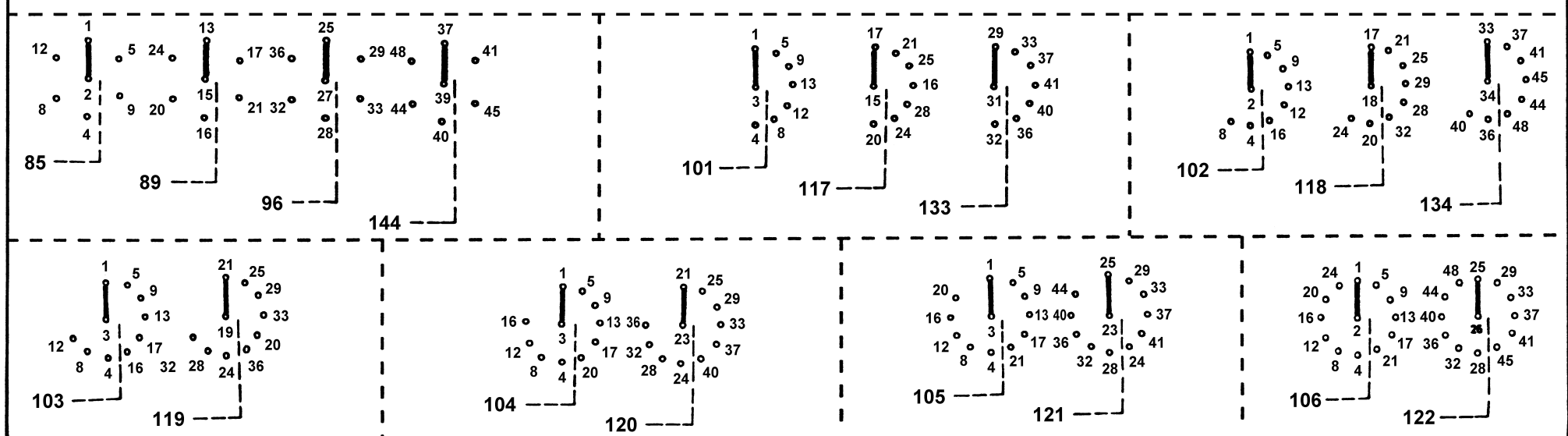

STEPENASTE SKLOPKE SA "0" POLOŽAJEM / MULTI-STEP SWITCHES WITH "0" / STOPENJSKA STIKALA S POLOŽAJEM "0"

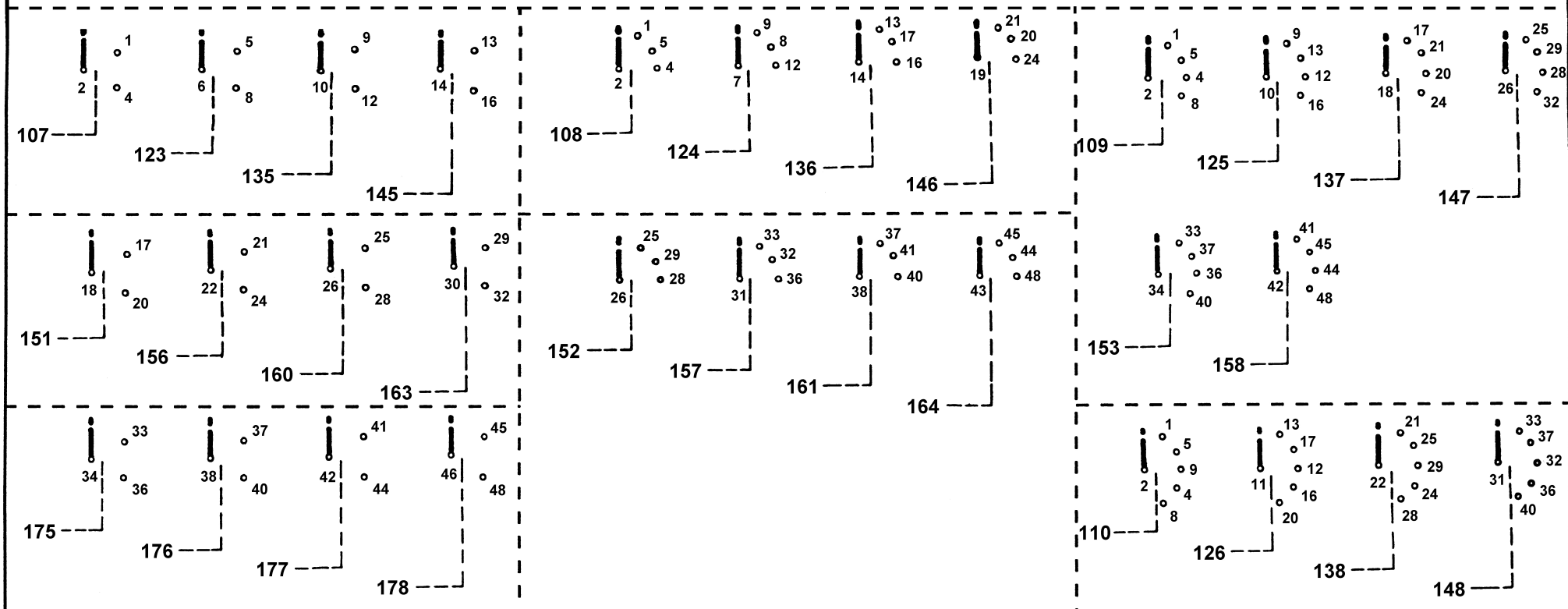

STEPENASTE SKLOPKE SA "0" POLOŽAJEM / MULTI-STEP SWITCHES WITH "0" / STOPENJSKA STIKALA S POLOŽAJEM "0"

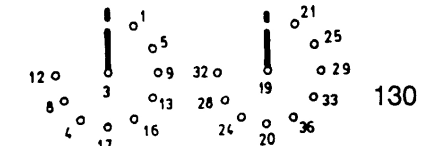
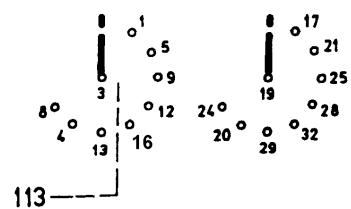
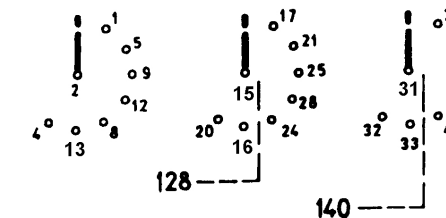
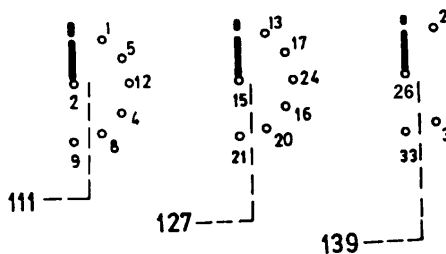
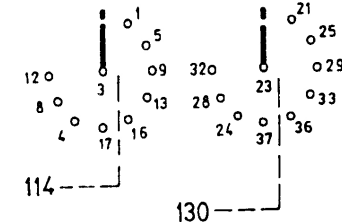
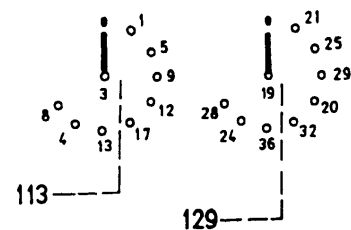
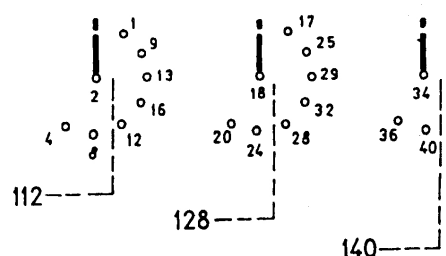
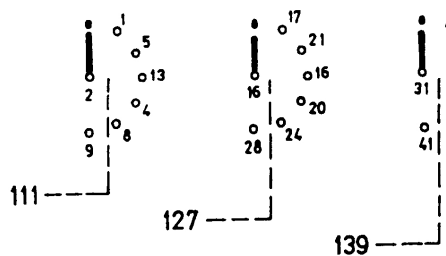

4G10, 4G16, 4G25
4G10H, 4G16H, 4G25H

4G10, 4G16, 4G25
4G10H, 4G16H, 4G25H

4G10, 4G16, 4G25
4G10H, 4G16H, 4G25H

4G10, 4G16, 4G25
4G10H, 4G16H, 4G25H

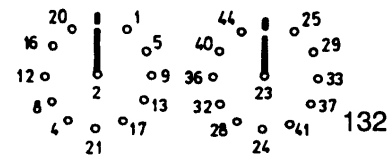
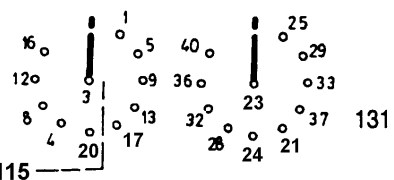
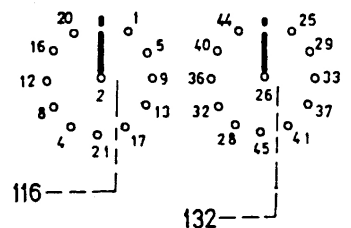
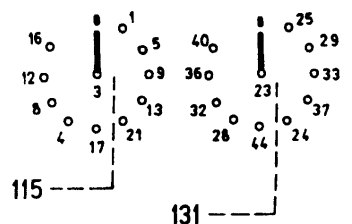

4G10, 4G16, 4G25
4G10H, 4G16H, 4G25H

4G10, 4G16, 4G25
4G10H, 4G16H, 4G25H

GRUPNE SKLOPKE / GANG SWITCHES / STIKALA ZA SKUPINSKO PREKLAPLANJE

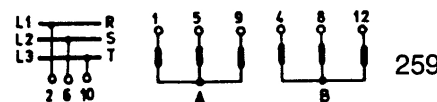
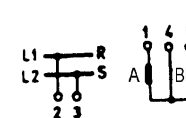
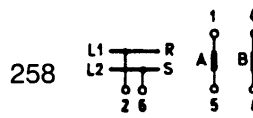
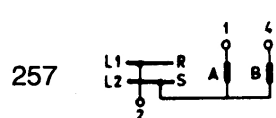
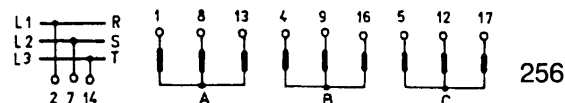
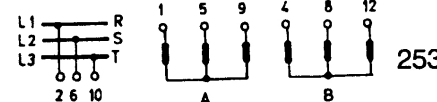
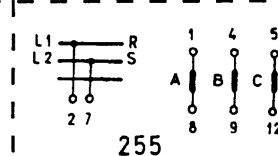
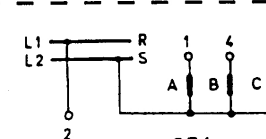
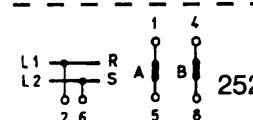
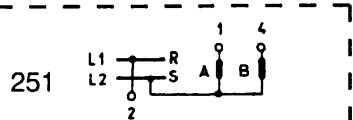

260